

SC800

Simplicity Design With Multi-tech Card Access Control Terminal



Compatible with
ZKBio Access IVS



SC800 is a Linux-based and waterproof RFID Access Control terminal that is designed for outdoor application. This terminal adopts a metal midframe housing and a 2.5D glass panel, supporting IP65 waterproof and IK04 vandal proof.

Besides, SC800 has a 2.4 inch color screen and a hidden touch keypad to enhance the touchless unlocking experience.

SC800 offers the multi-frequency RFID module that supports 125kHz and 13.56MHz card. In addition, SC800 supports Access Control push communication protocol and it is compatible with ZKBioAccess IVS software. This terminal also includes a Wiegand Input port to connect the external proximity reader and can be act as controller's external reader using a Wiegand Output port.

Features

- IP65 water and dust resistant, IK04 vandal proof
- Supports multiple RFID modules and up to 100+ card types (including, ID / IC / Legic / DESfire EV1 / EV2 / HID Prox. / HID iClass / etc.)
- Support Access Control push conversion to Time Attendance push
- Communication: TCP/IP, Wi-Fi (Optional), Wiegand in&out, RS485, OSDP (Ver2.1.7), RS232 (for printer)
- Embedded web server for system configuration
- Fully complied with ZKCSBL (ZKTeco Cyber Security Base Line). Standard to provide advance protection
- Compatible with ZKBio Access IVS

Specifications

Display	2.4 inch TFT LCD Color Screen
Operation System	Linux
Card Capacity	100,000
Logs Capacity	200,000
RFID	Standard Module: ID Optional Multi-tech Module: IC & ID / ID & IC & HID Proxy & HID iClass
Communication	TCP / IP, Wiegand, RS485, OSDP (Ver2.1.7), RS232 (only for printer), Wi-Fi (Optional)
Access Control Interface For	3rd party Electric Lock, Door Sensor, Exit Button, Alarm, Doorbell
Auxiliary Interface	1 AUX input
Indication Light	Breathing light: White, Status light: Red/Green

Data Protection	AES256
Keypad	Hidden Touch Keypad
Wiegand Signal	Wiegand In / Out
Standard Functions	ID card, Web sever, Automatic Status Switch, Self-Service Query, DST, 9 Digit User ID, Scheduled Bell, Anti-passback, HTTPS, Protocol convert (AC push to TA push)
Optional Functions	Wi-Fi, Multi-tech Card Module, Printer
Power Supply	DC 12V 3A
Operating Temperature	-10°C to 55°C (14°F to 131°F)
Storage Temperature	-20°C to 60°C (-4°F to 140°F)
Operating Humidity	10% to 90% RH
Dimensions (L*W*D)	143*85*19.8mm
Protocol	A & C Push (default) / T&A Push
Supported Software	ZKBioAccess IVS

Configuration

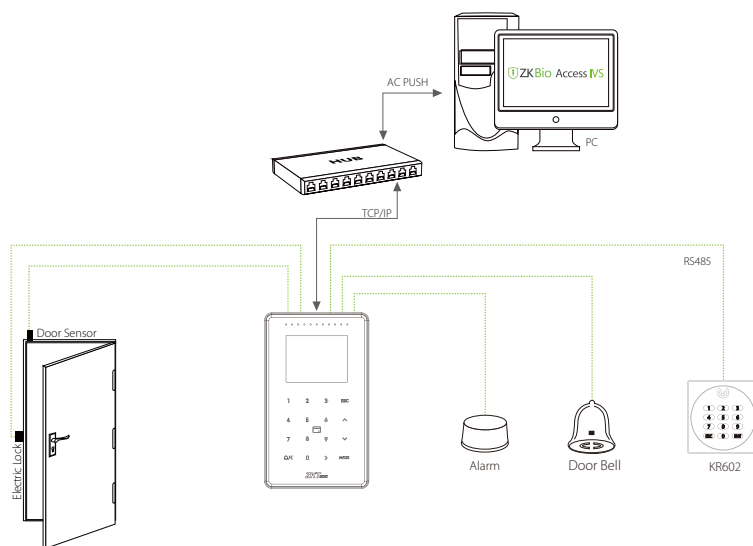

Dimensions(mm)

